

4 / A3.2 9-0008 - FD-1 - TYPICAL FLOOR DRAIN - SLAB ON GRADE

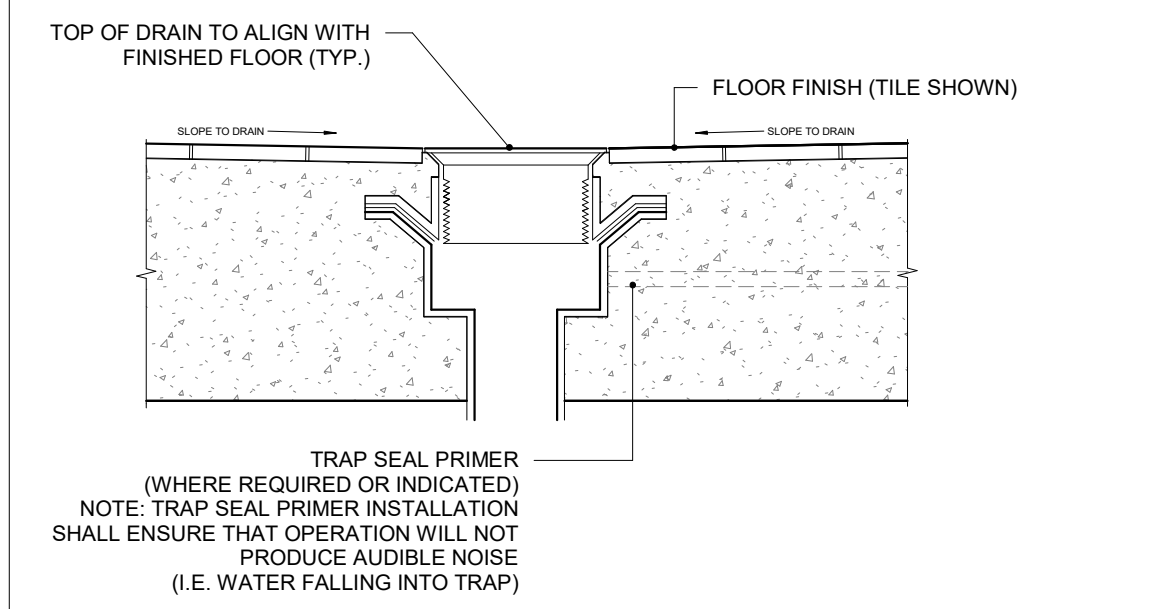

5 / A3.2 9-0008.1 - SD-1 - TYPICAL SHOWER DRAIN - SLAB ON GRADE

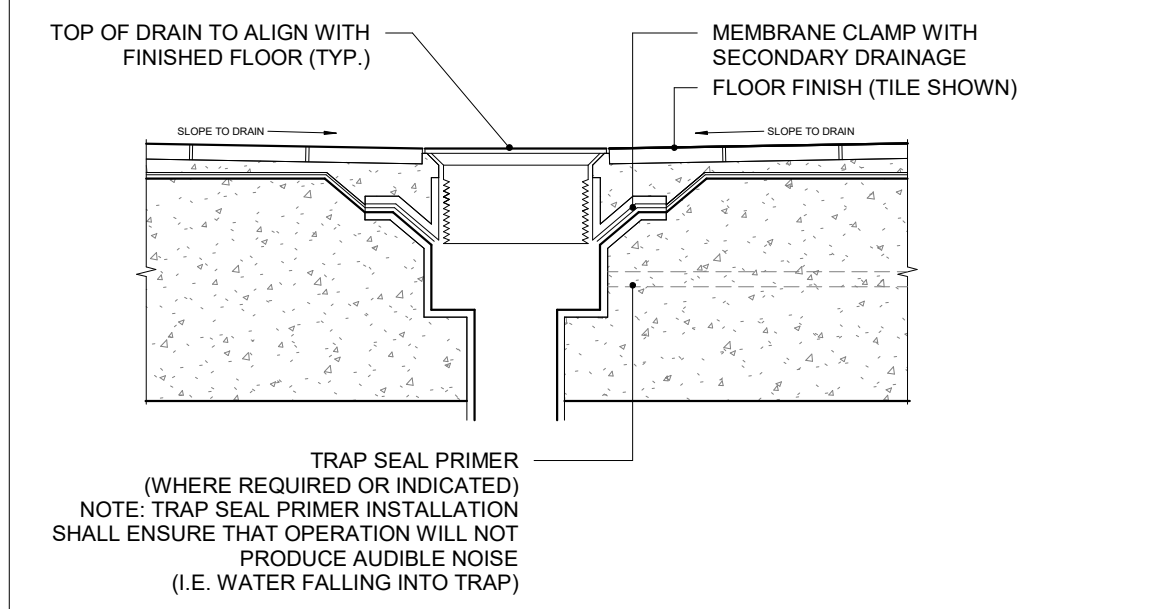

7 / A3.2 10-0001 - TD-1 - TRENCH DRAIN DETAIL

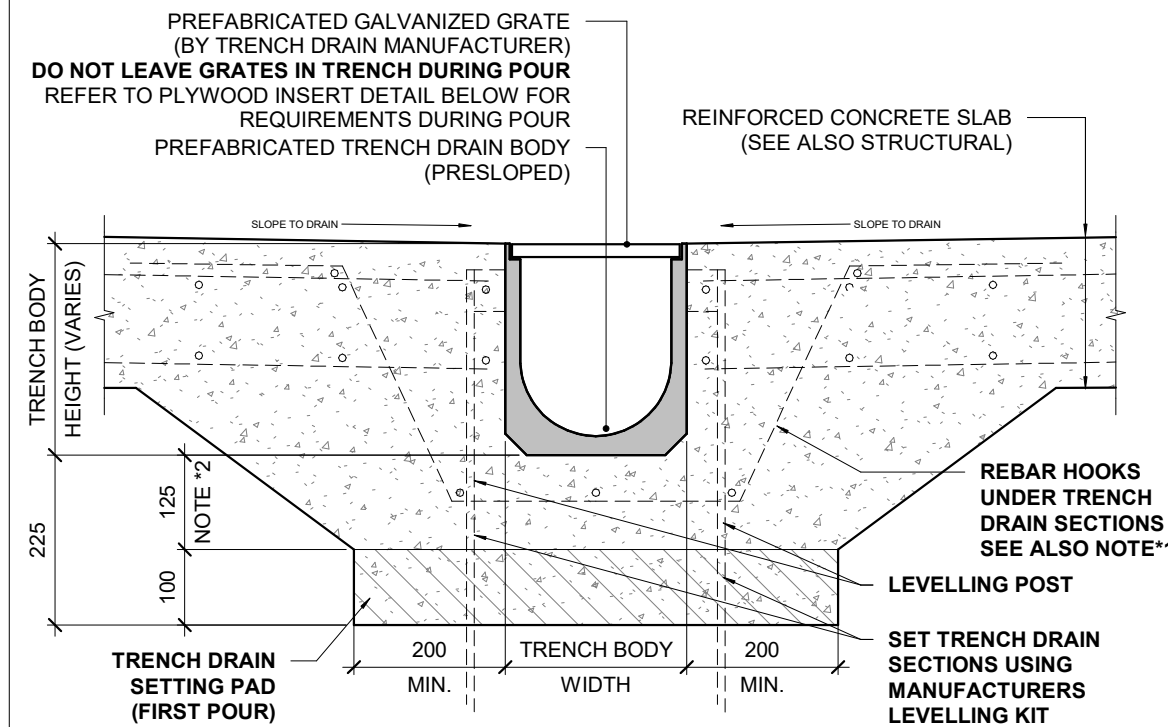

- NOTES:
- PRIOR TO SETTING TRENCH DRAIN SECTIONS, DETERMINE REQUIRED NUMBER OF HOOKS BETWEEN LEVELLING POSTS. LAY BARS BETWEEN POSTS ON SETTING PAD BEFORE SETTING DRAIN SECTION
 - SET TOP OF TRENCH DRAIN SETTING PAD MIN 125MM BELOW THE U/S OF THE DEEPEST TRENCH DRAIN SECTION IN THE RUN. COORDINATION WITH TRENCH DRAIN SUBMITTAL IS REQUIRED TO DETERMINE REINFORCING DIMENSIONS
 - THE INTENT OF THIS DETAIL IS TO FACILITATE PLACEMENT OF THE SLAB INCLUDING THE SPACE BENEATH THE TRENCH DRAIN IN A CONTINUOUS SINGLE POUR

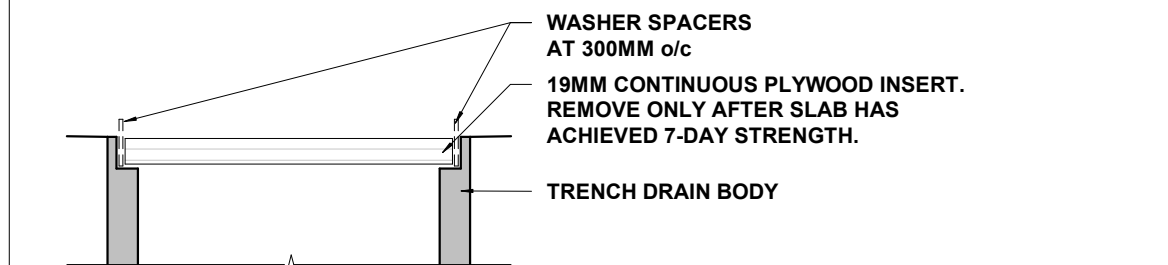

DETAIL: PLYWOOD INSERT DURING SLAB PLACEMENT (REMOVE GRATES)

- NOTES:
- SHOP DRAWING REQUIRED PRIOR TO FABRICATION
 - SEAL JOINTS IN TRENCH DRAIN PER MANUFACTURERS RECOMMENDATION
 - ENSURE CONTINUITY OF REINFORCING FROM ADJACENT SLABS THROUGH TRENCH DRAIN SETTING PAD
 - REMOVE GRATES AND INSERT 19MM PLYWOOD c/w WASHER SPACERS DURING POUR. DRAIN BODY FROM DAMAGE AND OR DEFLECTION DURING SLAB PLACEMENT

8 / A3.2 3-0003 - CJ - TYPICAL CONCRETE JOINTS

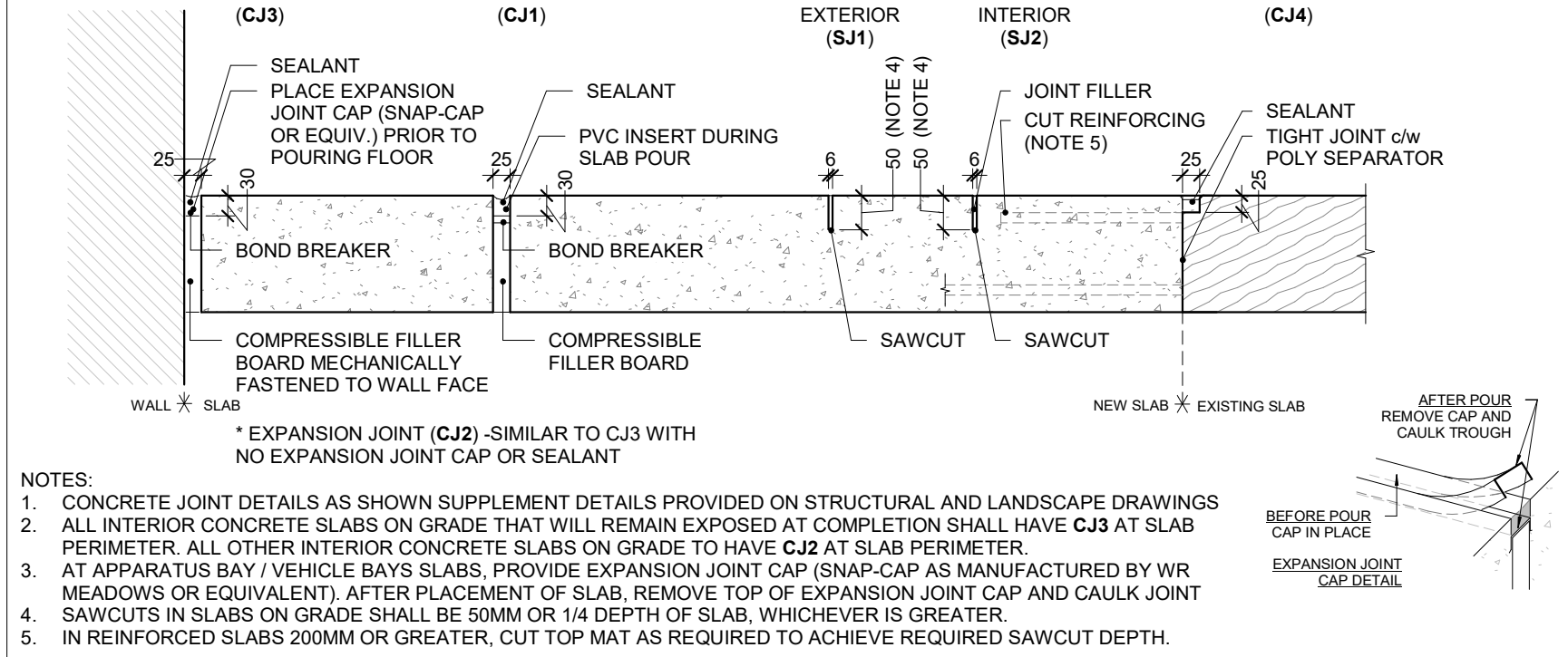

- NOTES:
- CONCRETE JOINT DETAILS AS SHOWN SUPPLEMENT DETAILS PROVIDED ON STRUCTURAL AND LANDSCAPE DRAWINGS
 - ALL INTERIOR CONCRETE SLABS ON GRADE THAT WILL REMAIN EXPOSED AT COMPLETION SHALL HAVE CJ3 AT SLAB PERIMETER. ALL OTHER INTERIOR CONCRETE SLABS ON GRADE TO HAVE CJ2 AT SLAB PERIMETER
 - AT APPARATUS BAY / VEHICLE BAYS SLABS, PROVIDE EXPANSION JOINT CAP (SNAP-CAP AS MANUFACTURED BY WR MEADOWS OR EQUIVALENT). AFTER PLACEMENT OF SLAB, REMOVE TOP OF EXPANSION JOINT CAP AND CAULK JOINT
 - SAWCUTS IN SLABS ON GRADE SHALL BE 60MM OR 1/4 DEPTH OF SLAB, WHICHEVER IS GREATER
 - IN REINFORCED SLABS 200MM OR GREATER, CUT TOP MAT AS REQUIRED TO ACHIEVE REQUIRED SAWCUT DEPTH

2 / A3.2 3-0005 - SE-1 - SLAB EDGE DETAIL

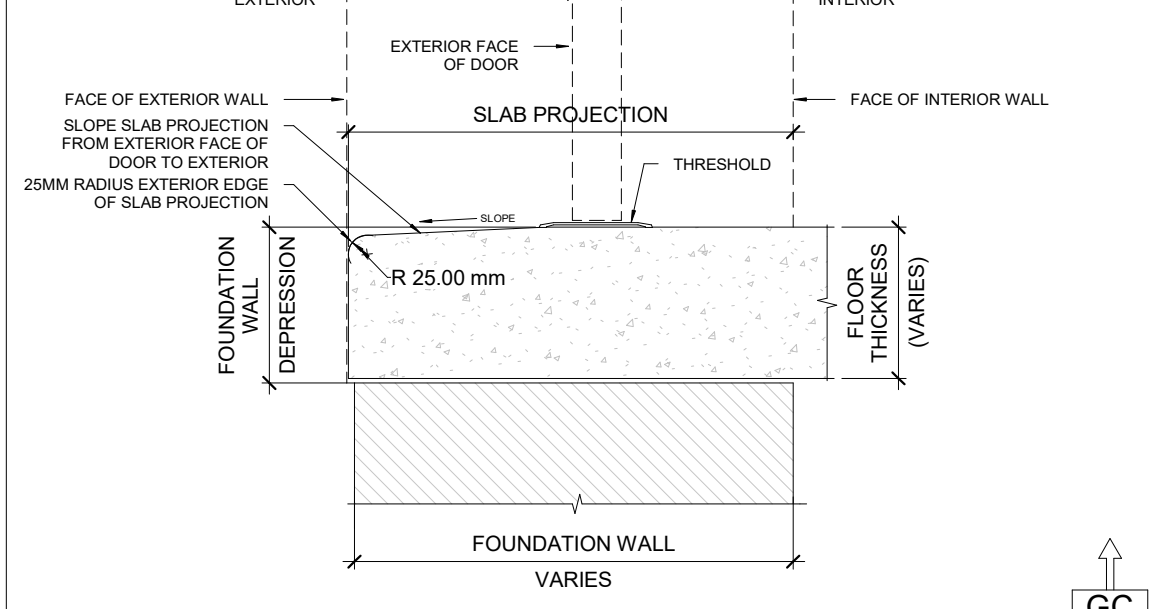

1. DETERMINE THE LOCATION OF DOOR EXTERIOR FACE AND ENSURE THAT THE SLAB PROJECTION SLOPES DOWN FROM THIS POINT TO THE EXTERIOR. UNDER NO CIRCUMSTANCES SHALL WATER BE DIRECTED TOWARD BUILDING

3 / A3.2 3-0006 - SE-2 - SLAB EDGE DETAIL BAY DOORS

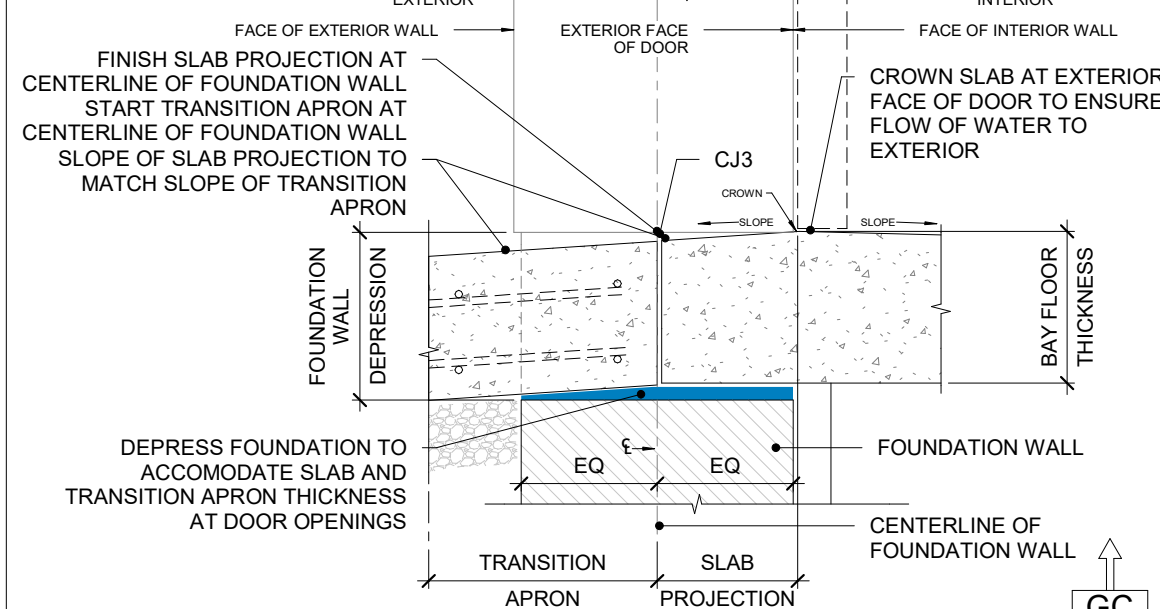

1. DETERMINE THE LOCATION OF DOOR EXTERIOR FACE AND ENSURE THAT THE SLAB PROJECTION SLOPES DOWN FROM THIS POINT TO THE EXTERIOR. UNDER NO CIRCUMSTANCES SHALL WATER BE DIRECTED TOWARD BUILDING

1 LAYOUT PLAN - FOUNDATION & GROUND FLOOR 1:75

LA SERIES LEGEND IDENTIFICATION

- SHADING INDICATES FLOORS
- INDICATES OF ROOF DECK DIMENSION
- SHADING INDICATES ROOF DECK

DIMENSIONING AND DETAILING

- SHADED WALLS ARE DIMENSIONED TO FACE OF STUD
- INDICATES SLAB OR FOUNDATION WALL DEPRESSIONS
- INDICATES ROOF DIVIDERS AND/OR FRAMED UPSTANDS WHERE ROOF DECK ABUTS VERTICAL WALL

NOTE
A - CONCRETE UPSTAND
RAISED CONCRETE FOUNDATION WALL FOR FERRO BRACKET AT BRICK LOCATIONS

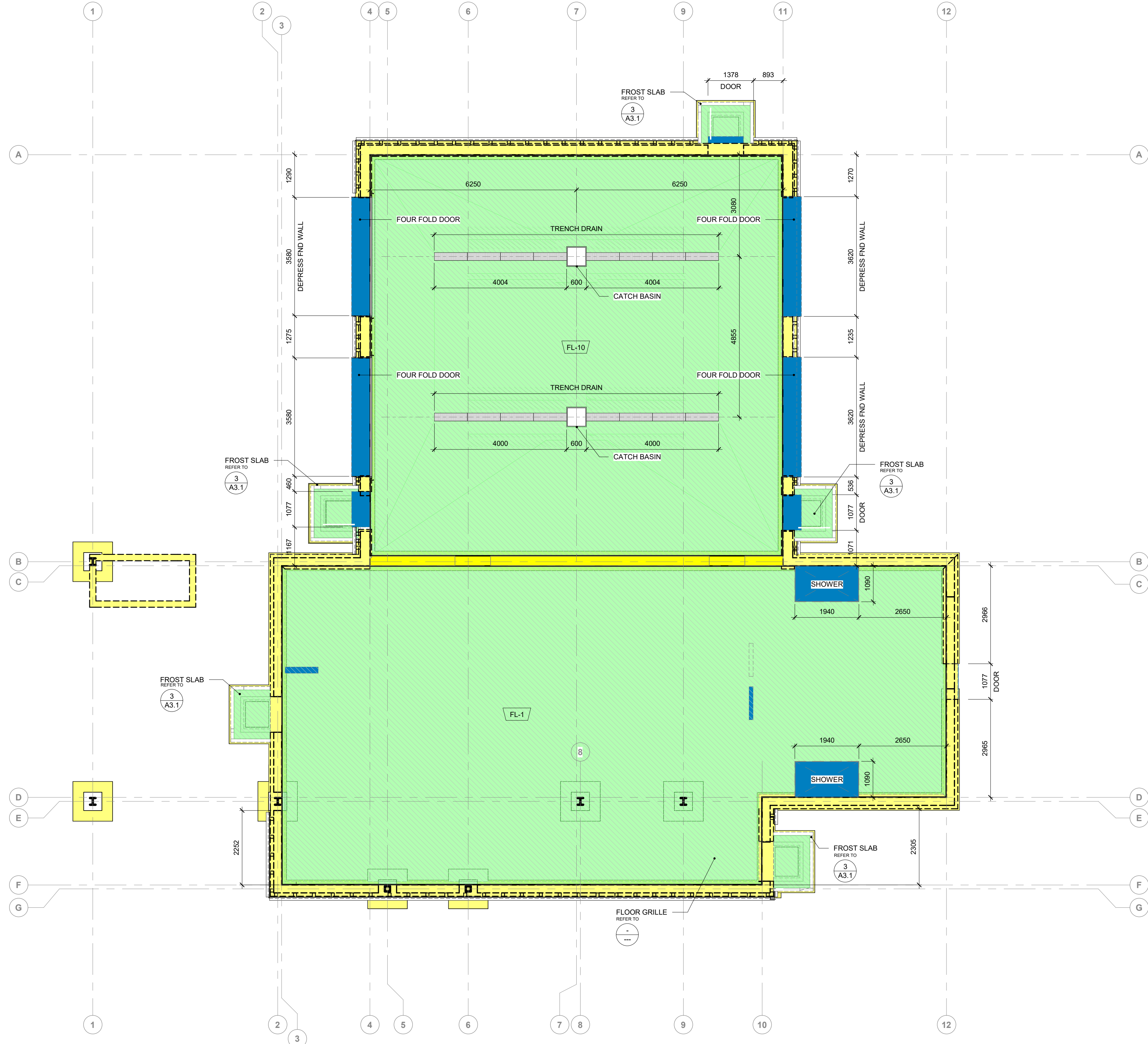

THE CONTENTS OF THIS DRAWING AND SPECIFICATIONS
REMAIN THE COPYRIGHT PROPERTY OF
THOMAS BROWN ARCHITECT INC.
AND MUST BE RETURNED UPON COMPLETION OF THE WORK.

ISSUE OR REVISION		
NO.	ISSUED FOR	DATE
8	90% CONTRACT DOCUMENTS	2020.12.03
12	BUILDING PERMIT	2023.07.07
14	100% CLIENT REVIEW PRE-TENDER	2023.10.17
19	TENDER	2025-10-30
20	ADDENDUM #3	2025-21-16

YORK REGION PRS #33 RFTC
397-21
2960 TESTON ROAD, VAUGHAN

PROJECT:

CLIENT

THE CONTRACTOR SHALL VERIFY ALL DIMENSIONS PRIOR
TO COMMENCEMENT OF THE WORK. ANY DISCREPANCIES
ARE TO BE REPORTED TO THE CONSULTANT

ARCHITECT
THOMASBROWNARCHITECTS
187 SPADINA AVENUE, SUITE 500 | TORONTO ONTARIO | M5T 2C8

PROFESSIONAL SEAL

DWG TITLE

LAYOUT PLAN -
FOUNDATION &
GROUND FLOOR

ORIENTATION

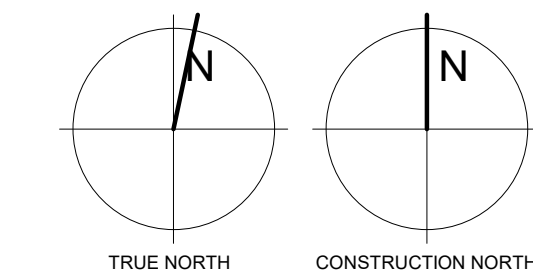

DATE 2020-11-18

PROJECT NO.

1622

DRAWING NO.

A3.2

REVISION

20

2025-12-16 1:35:20 PM